

# RESIDENCE 5B

5<sup>TH</sup> FLOOR      INTERIOR: 655 SF  
 1 BEDROOM      EXTERIOR: 82 SF  
 1 BATHROOM      TOTAL: 737 SF

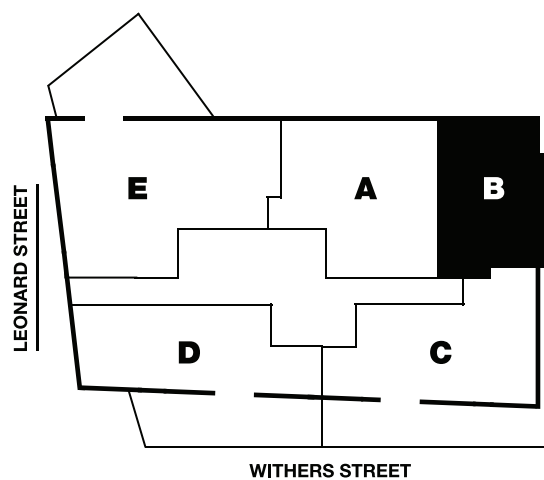

element  
**88**  
WILLIAMSBURG

ALL DIMENSIONS ARE APPROXIMATE TO NORMAL CONSTRUCTION VARIANCES AND TOLERANCE. SPONSOR RESERVES THE RIGHT TO MAKE CHANGES AS DEEMED NECESSARY AND IN ACCORDANCE WITH THE OFFERING PLAN AND AMENDMENTS.

**NOTE 1:** Ceiling Heights in Areas of Mechanical Communications are 10'5"  
**NOTE 2:** Living Room and Bedroom Ceiling Heights are 11'8"