

## RESIDENCE 6D

6 <sup>TH</sup> FLOOR	INTERIOR: 918 SF
2 BEDROOMS	EXTERIOR: 267 SF
1 BATHROOM	TOTAL: 1185 SF

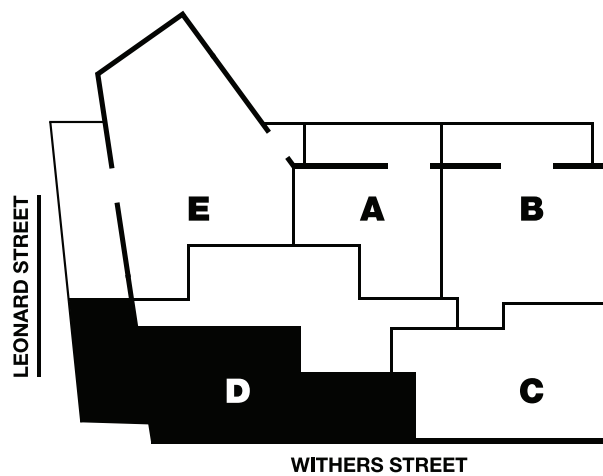

element  
**88**  
WILLIAMSBURG

ALL DIMENSIONS ARE APPROXIMATE TO NORMAL CONSTRUCTION VARIANCES AND TOLERANCE. SPONSOR RESERVES THE RIGHT TO MAKE CHANGES AS DEEMED NECESSARY AND IN ACCORDANCE WITH THE OFFERING PLAN AND AMENDMENTS.

**NOTE 1:** Ceiling Heights in Areas of Mechanical Communications are 10'5"

**NOTE 2:** Living Room and Bedroom Ceiling Heights are 11'8"